

# Bedfords Park Walled Garden

*Kirsty McArdle*  
*Project Manager*  
*078 645 645 04*

*info@bedfordswalledgarden*  
[www.bedfordswalledgarden.org](http://www.bedfordswalledgarden.org)

# Bedfords Park Walled Garden

## Location

*If you don't know where it is, one of Havering's best kept secrets, this map should help.*

*Full directions on the website*

[www.bedfordswalledgarden.org](http://www.bedfordswalledgarden.org)

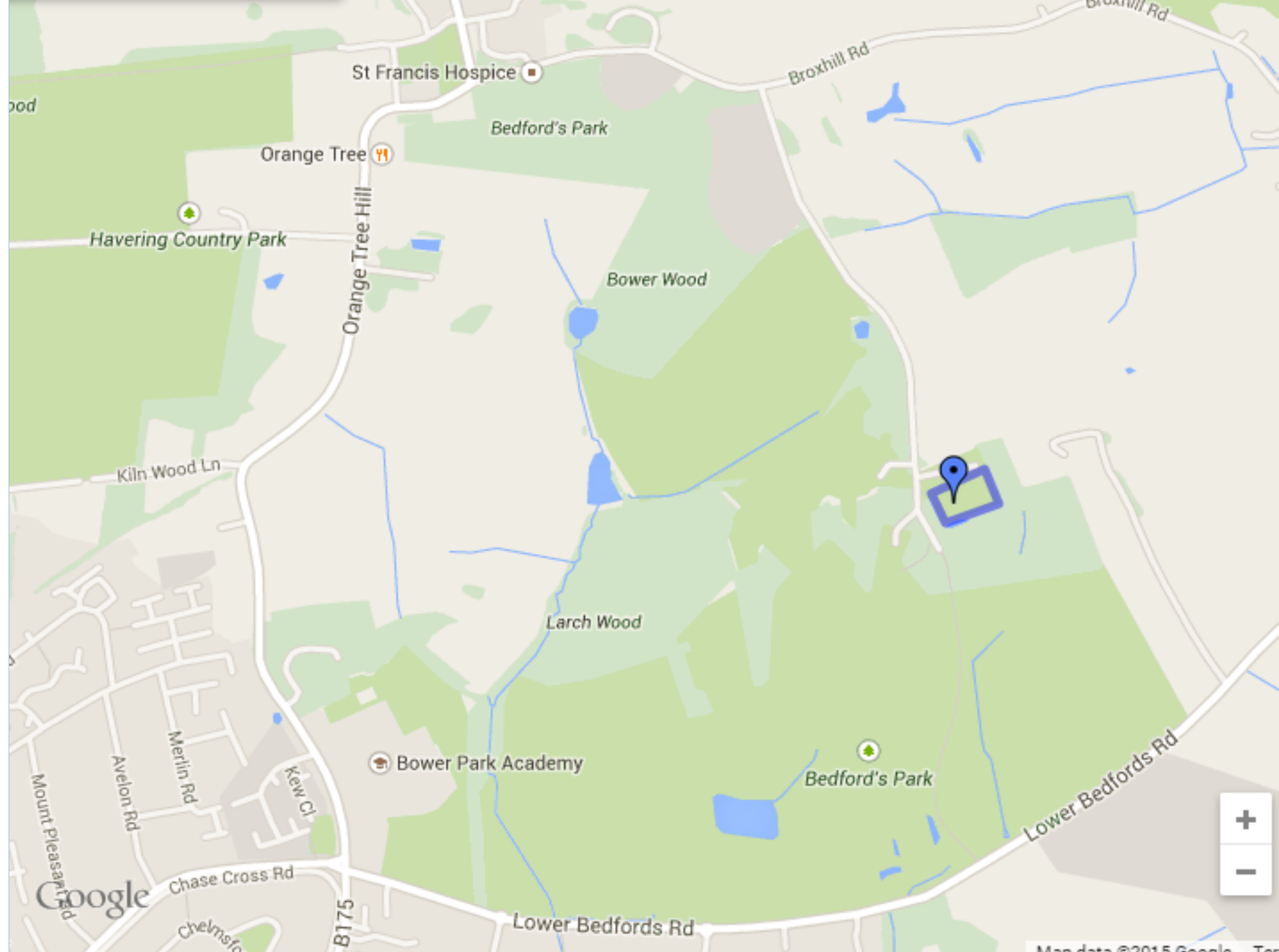

# Bedfords Park Walled Garden

## Ground plan

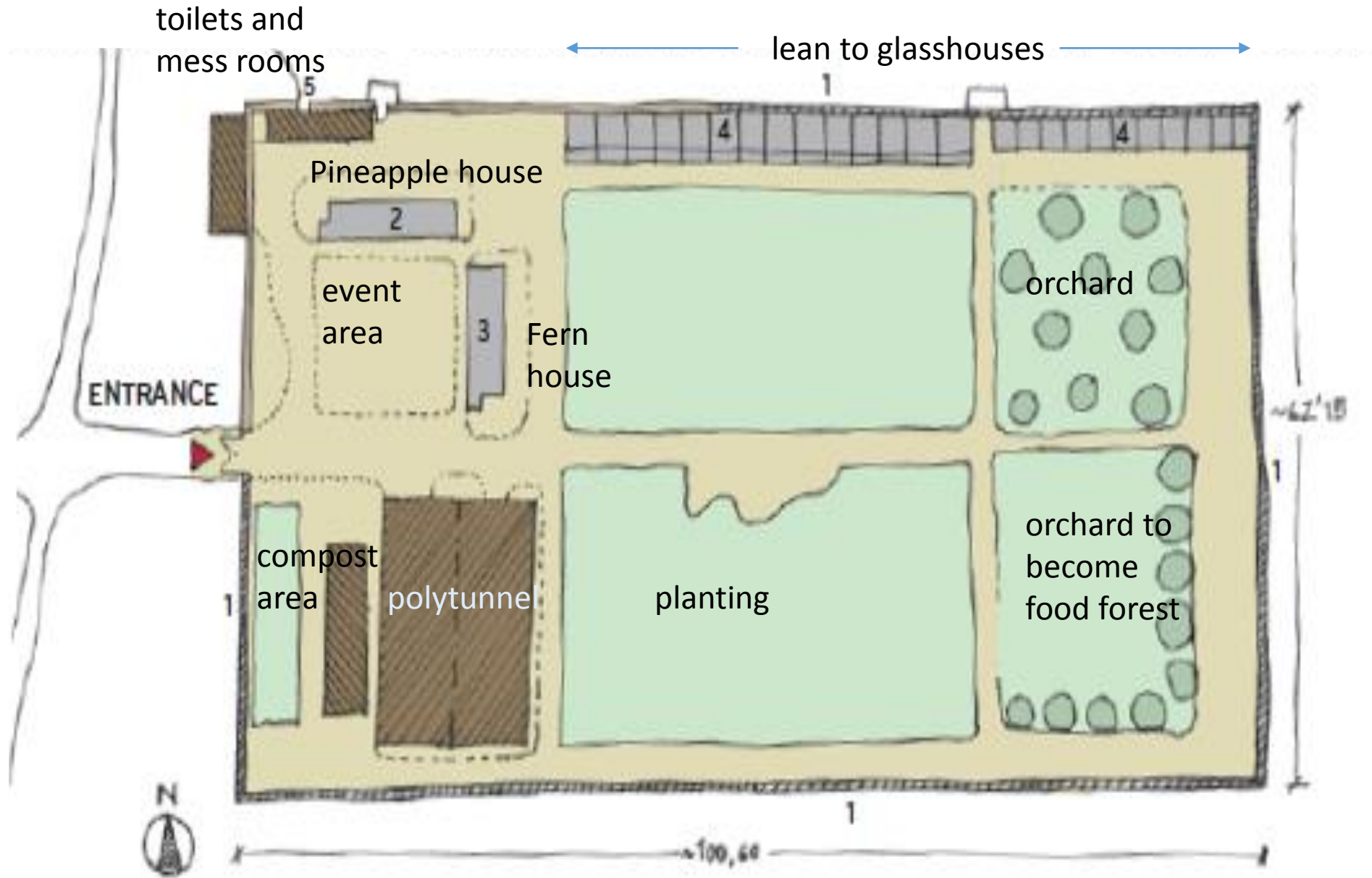

*The general layout of the garden.*

*It's the size of a football pitch!*

*0.6 of a Hectare*

*1.5 Acres*



# Bedfords Park Walled Garden

## Beginnings...

*We arrived on site April 2013 to  
this jungle and all the buildings  
derelict and vandalised*





# Bedfords Park Walled Garden

## West Wall

*Part of the West Wall had fallen down and we had commissioned an engineer's report to tell us of the state of all of the walls – more later.*

*First job was to rebuild this wall.*





# Bedfords Park Walled Garden

## Today

*We used hand made imperial size bricks and the Council helped us choose the closest to the original bricks. We decided to build it all from new bricks and use the originals to patch the other walls.*





# Bedfords Park Walled Garden

April 2013



*The council helped to clear the site, a great help.*

*But after digging a soil profile we realised there was no topsoil. The whole site had been glasshouses from 1960s and so the topsoil had been removed*



# Bedfords Park Walled Garden

May 2013



*...so we bought topsoil and  
started planting*

*This is Paul planting the potato  
patch.*

*The inset was the corn growing in  
toiletroll holders*





# Bedfords Park Walled Garden

June 2013

*Potatoes coming up in the  
background, and Merrin creating  
this wigwam for the beans*





# Bedfords Park Walled Garden

June 2013

*An aerial view from the roof of the  
toilet block.*

*The foreground was the corn  
maise/maze*





# Bedfords Park Walled Garden

June 2013

*Great view of the derelict Fern  
House which still had its original  
Victorian bricks but we couldn't  
save the wooden structure  
And the newly covered polytunnel*





# Bedfords Park Walled Garden

July 2013

*Potatoes doing well and some of  
the north wall being repaired*





# Bedfords Park Walled Garden

From the air



*Goodgle Earth shows the garden  
from the Summer 2013*

*You can see the corn maze and  
the potato patch clearly but you  
can also see the huge amount of  
work still to do!*



# Bedfords Park Walled Garden

June 2013



*The first event was Midsummer's  
Night—story telling in the potato  
patch, the bees swarmed and we  
had lots of visitors*





# Bedfords Park Walled Garden

July 2013

*Starting to grow tomatoes in the  
polyrunnel*

*Watering being an endless task!*





# Bedfords Park Walled Garden

August

*Didn't take long - the polytunnel  
full of delicious organic edibles...*

*Tomatoes, cucumber, melons,  
chillies and peppers*





# Bedfords Park Walled Garden

## August

*Our corn was 6 to 7 feet tall*

*And with 2 to 3 cobs on each  
plant we didn't know what to do  
with it all!*





# Bedfords Park Walled Garden

August

*Abundance !*





# Bedfords Park Walled Garden

## September

*Cinderella the biggest pumpkin in  
the garden*





# Bedfords Park Walled Garden

## September

*We teach schoolchildren about  
the history of the potato  
'conquistadors to chips'*

*And about the history of the  
carrot and why they're orange*

*All at the Schools Harvest  
Festival*





# Bedfords Park Walled Garden

September 13

*The Harvest Moon (Harvest  
Moon Festival) was a sight to  
behold !*

*(this pic isn't touched up!)*





# Bedfords Park Walled Garden

September

*Abundance !*





# Bedfords Park Walled Garden

## October

*Still plenty to do*

*And this is our youngest  
volunteer*





# Bedfords Park Walled Garden

## November

*Work never stops !*





# Bedfords Park Walled Garden

## Walls, prep

*Ivy, that could have been 100 years old had to come off the walls before they could be inspected for damage and repaired.*

*In places the soil accumulated was 6 inches deep on top of the wall!*





# Bedfords Park Walled Garden

## North wall



*Lots of ivy and lots of repairs –  
the builders try to dig it off the  
wall!*

*And prep for the lean to  
glasshouse installation*



# Bedfords Park Walled Garden

## East wall



*Large ivy plant on North wall*

*The East wall being held up by  
props as it was leaning, and had  
been leaning for 30/40 years*



# Bedfords Park Walled Garden

## East wall

*The engineer reported the lean  
on the east wall between 10 & 15  
cm (4-6 inches)*

*And said that the props were  
inadequate*





# Bedfords Park Walled Garden

## East wall

*You can see the lean of the East wall by the blue lines.*

*The lean was first measured in Oct 2013. When measured again in March 2014 the wall was leaning by 40cm (15inch) and was in danger of falling over any minute!*





# Bedfords Park Walled Garden

## East wall

*There was no choice but to take it down and rebuild it.*

*Our builders loved it as they were surrounded by bluebells as they worked.*

*You can clearly see the 40cm gap as Mark reattached the buttress to the wall*





# Bedfords Park Walled Garden

April 2014

*With the north wall repaired the  
building of the lean to  
glasshouses began*





# Bedfords Park Walled Garden

## Lean tos

*The first 40m of lean to  
glasshouses today*

*The coldframes waiting for their  
tops*

*Water harvesting butts catching  
the water from the roof*





# Bedfords Park Walled Garden

## Fern House

*A sorry state and found out when we took a closer look that it was more rotten than we originally thought.*

*It wasn't possible to salvage the original (1960's) cedar frame*





# Bedfords Park Walled Garden

... close up



*It all had to come down.*

*And the brick walls rebuilt too as  
there was no lime mortar left  
between them*





# Bedfords Park Walled Garden

## Fern House

*The walls rebuild with the originals and some reclaimed Victorior imperials to match.*

*It had to be restored in yellow brick, not red. This was a Victorian building on the original footprint of a Georgian building but we don't know what it looked like*





# Bedfords Park Walled Garden

Today

*The original yellow bricks possibly came from a brickyard in Havering at Bower.*

*The Victorian building was built on the original footprint of a Georgian building but we don't know what that looked like. So we went Victorian.*





# Bedfords Park Walled Garden

## Pineapple Hs

*The Pineapple House as we found it.*

*It's on the original footprint of the Georgian Pineapple House with the original adapted for sowing and seedlings in the 1960's.*





# Bedfords Park Walled Garden

Today



*Although not in its original style  
we'll still be growing pineapples.*

*The manure pen constructed as  
the blue lines show will heat the  
space to the tropical climate  
that's needed*





# Bedfords Park Walled Garden Classroom



*The classroom arrived May 2014*

*And we started the children's  
programme 'Grow>Cook>Eat in  
that summer*



# Bedfords Park Walled Garden

## Office & shop





# Bedfords Park Walled Garden

## Pizza Oven

*We love our pizza oven and fire it up regularly for events.*

*It cooks pizzas in seconds!*





# Bedfords Park Walled Garden

## Well

*The original Georgian well was full of debris and cleaned out and the bricks cleaned too.*

*The water runs through the garden and seeps through the porous bricks lining the wall.*





# Bedfords Park Walled Garden

Today



*The finished well.*

*It contains a pump and we use it  
for irrigation instead of mains  
water.*





# Bedfords Park Walled Garden

## Drainage



*We found an original land drain in the garden and realised that the pond outside of the garden is the overspill.*

*This is why there is never any standing water in the garden.*



# Bedfords Park Walled Garden

## Drainage

*The original underground coal bunker that drove the steam engine to heat the north wall has been given a new lease of life as the main water storage tank, It holds approx. 12 tonnes of water gathered from the lean-to roofs*





# Bedfords Park Walled Garden

## Drainage

*This modern pump house that we lovingly call the bird house (as Tits nest in the cracks in the walls) has been restored to also be a watertank.*

*The door and window have been left open and so have the cracks so the birds can still nest*





# Bedfords Park Walled Garden

## Future plans

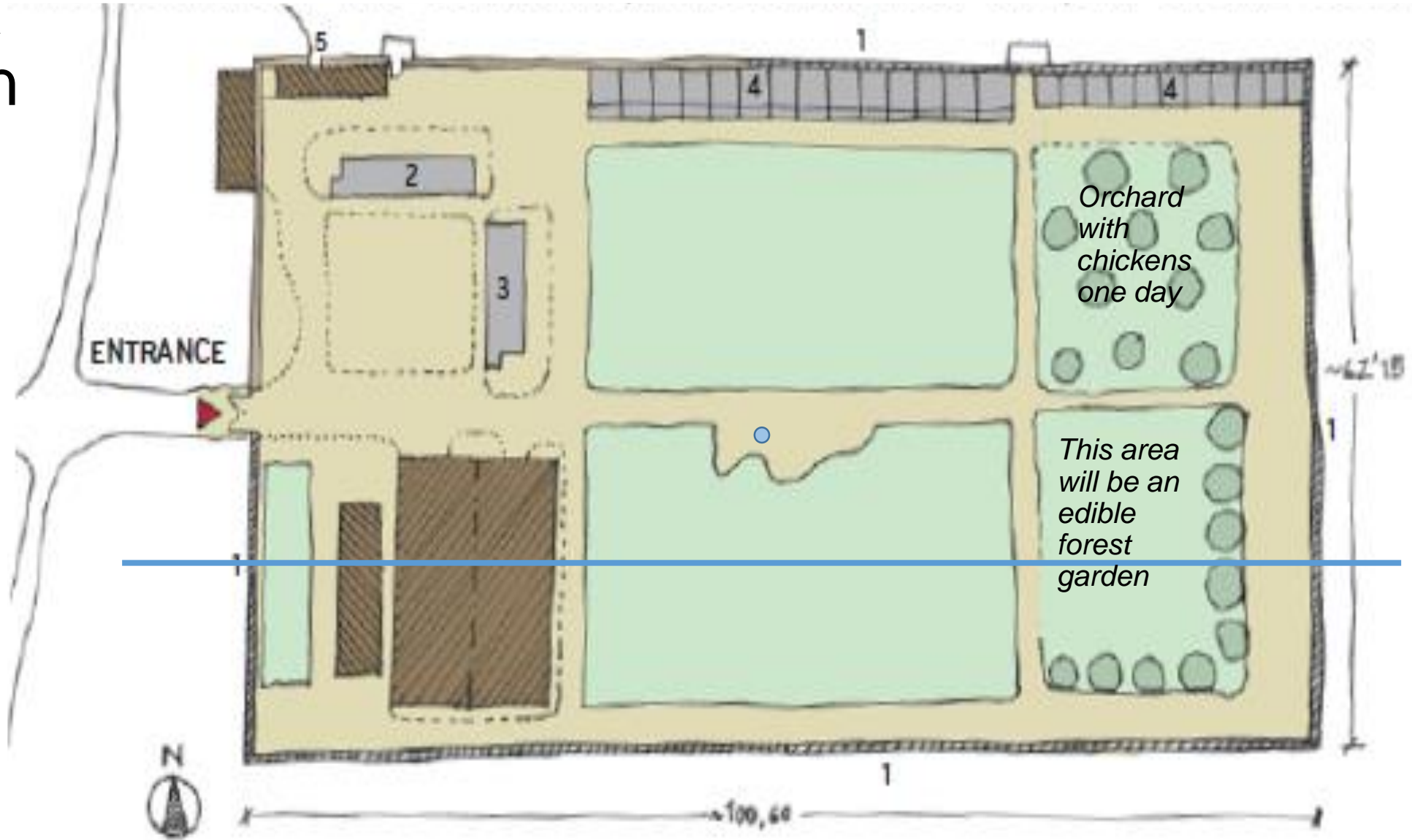

*Still a lot of planting to do and special consideration needed in the shade line as indicated here where only broad-leaved perennials like Rhubarb thrive.*



# Bedfords Park Walled Garden

## Future plans

*The polytunnel will need replacing soon as the lining's starting to deteriorate*

*New gates will arrive in the summer 2015 and the old gates will become tables in the event area*





# Bedfords Park Walled Garden People



*At the end of the day the garden  
is all about people*



# Bedfords Park Walled Garden

## Future



# LOTTERY FUNDED

*We received a Big Lottery  
Reaching Communities grant of  
£333, for 3 years*



# Bedfords Park Walled Garden

Children

Grow>Cook>Eat



School holidays and Saturdays

Holistic approach to teaching kids about healthy eating

*Our children's programme is very  
successful*

>Classroom activities

>Gardening

>They make their own lunch



# Bedfords Park Walled Garden

Over 50's

“Growing Friends”



Monthly club on Wednesday  
Launch Sunday 10<sup>th</sup> May 2015

*A new club on the first  
Wednesday of the month*

*After the launch on 10<sup>th</sup> May the  
first club meeting is Wednesday  
3<sup>rd</sup> June 2015*

- > Gardening
- > Community/social
- > Health, wellbeing, exercise
- > Workshops and activities



# Bedfords Park Walled Garden

Unemployed

Training



Certificated horticulture training

- >Independence
- >Confidence
- >Better chance of employment
- >Health, wellbeing & exercise

*Seetec provide unemployed people with work placements in the garden and we've been in partnership with them since the beginning*

*Further training in horticulture will begin in Sept 2015*



# Bedfords Park Walled Garden

## Learning difficulties

## Training



## Certificated horticulture training

- >Independence
- >Confidence
- >Better chance of employment
- >Health, wellbeing & exercise

*Training for young adults with moderate learning difficulties will begin in September 2015*

*Mind the partners the Richmond Fellowship and Havering Adult Collage support people with learning difficulties and send them to the garden to volunteer*



# Bedfords Park Walled Garden

## Young Offenders

## Training



## Horticulture training

- >Independence
- >Confidence
- >Better chance of employment
- >Health, wellbeing & exercise

*Young offenders will be given horticulture training as well as other project to offer them more chances in life through doing some constructive work*



# Bedfords Park Walled Garden

## Volunteering

## Community



Tuesdays and Thursdays  
10am to 3pm

*Our garden members volunteer regularly and have themselves formed the backbone of the wonderful friendly community in the garden.*

*We're not only grateful but couldn't do without them.*

- > Gardening
- > DIY
- > Work to own pace
- > Tasks that are enjoyable for individual
- > Gates are open for visitors



# Bedfords Park Walled Garden

AND...



*We run festival events and  
activities for everyone*



# Bedfords Park Walled Garden

Thank you

*The work never stops and life  
flourishes.*

*It's a joy!*

